

# Installation Instructions

## ! IMPORTANT

- DISCONNECT ELECTRICAL SUPPLY BEFORE INSTALLATION OR SERVICING.
- THIS PRODUCT MUST BE EARTHED.
- THIS PRODUCT IS DESIGNED TO OPERATE OUTDOORS. IF REQUIRED TO BE USED INDOORS PLEASE CONSULT DW WINDSOR.
- THIS PRODUCT IS FITTED WITH HIGH IMPACT RESISTANT GLASS AND MAY BE MOUNTED AT HEIGHTS ABOVE OR BELOW 5m.

IP66 IK08   

230VAC 50Hz

## Product Details

The Kirium Pro range is supplied with entry detached from the lantern.

	Dimensions (mm)			Max. Weight (kg)*	Windage m <sup>2</sup>
	A	B	C		
Kirium Pro Midi	451	119	227	5.04	0.034 (CxS=0.026)

\*Maximum weight of lantern including post top entry.

	Power Ranges (Watts)	
	Standard	CLO Enabled
Kirium Pro Midi	17-79	15-71

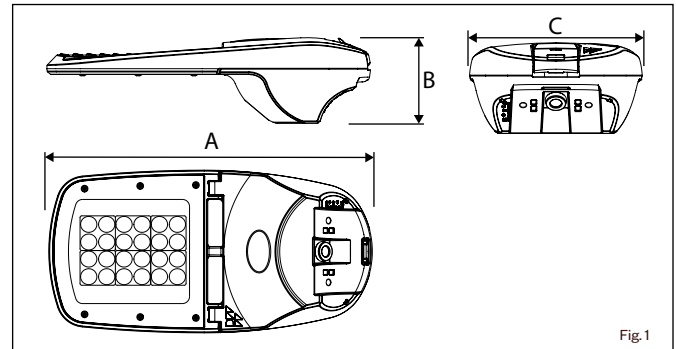

Fig. 1 - Kirium Pro Midi

## Column Engagement

The information shown below details the length of column engagement for each entry option.

Entry Options	Column Engagement (L)
76mm Post Top Entry	80mm
42mm Side Entry	110mm
60mm Post Top and Side Entry	100mm

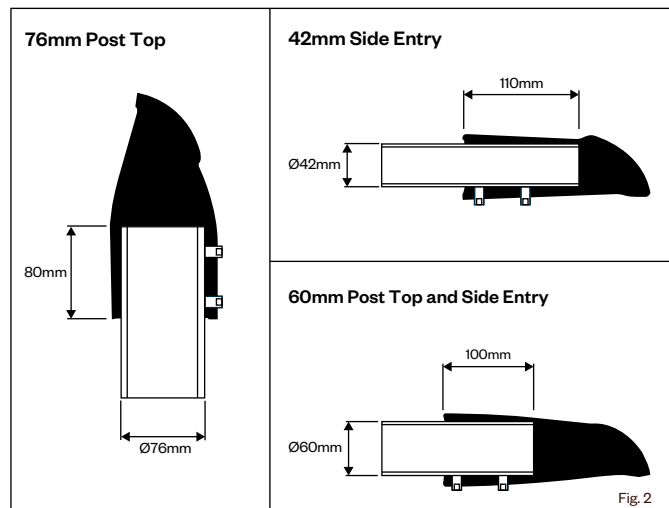

Fig. 2 - Length of column engagement for each entry option.

## Fasteners Supplied

- 2x M10 Screw
- 4x Disc Spring Washer
- 2x M10 Grub Screw

## Tools Required

Tools not supplied.



## Recommended Torque

	Entry Mounting Torque (Nm)	Column Mounting Torque (Nm)
Kirium Pro Midi	15	16

## NOTE!



- Luminaire to be positioned so that prolonged staring into the luminaire at distances closer than 3.0m is not expected.
- Do not stare at operating light source.
- Personnel to wear Protective Safety Glasses compliant with EN166 1F/ EN169 - 5 when commissioning or maintaining this luminaire.

Kirium® Pro is a registered design

Due to continuous product development the details within this document are subject to change at any time, please contact us for the most up-to-date information or visit: [www.dwwindsor.com](http://www.dwwindsor.com)

DW Windsor

Pindar Road, Hoddesdon, Hertfordshire, EN11 0DX  
T: +44 (0) 1992 474600 | E: [info@dwwindsor.com](mailto:info@dwwindsor.com)

[www.dwwindsor.com](http://www.dwwindsor.com)

## Kirium Pro Midi Installation Steps | Post Top Entry

### Step 1

Pierce rubber film on membrane cable gland with an appropriate tool such as a philips head screwdriver before attempting cable input

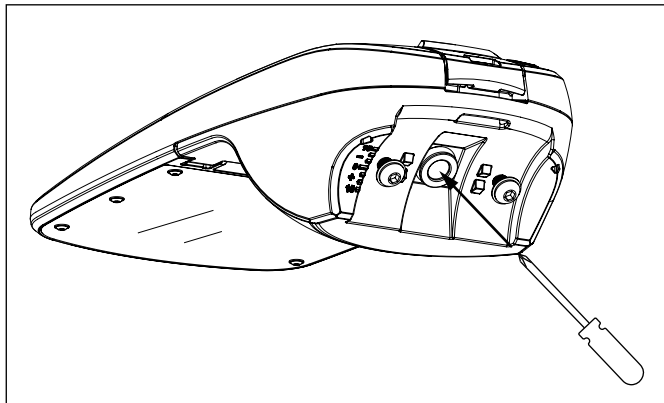

### Step 2

Loosen and remove pre-attached 2x M10 screws and 4x disc spring washers from lantern with torque wrench (6mm).

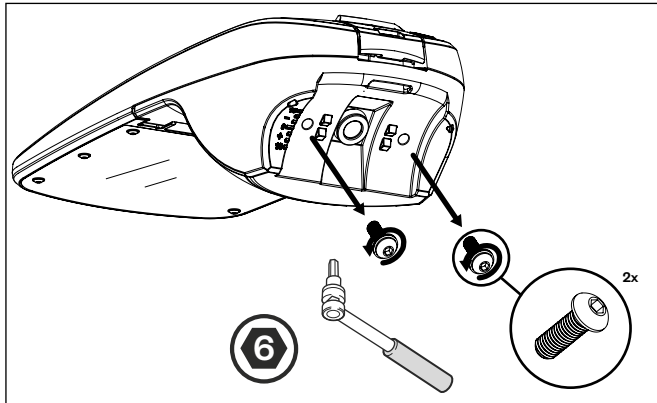

### Step 3

To feed the cable into the lantern the cable must go through the entry first and then through membrane cable gland.

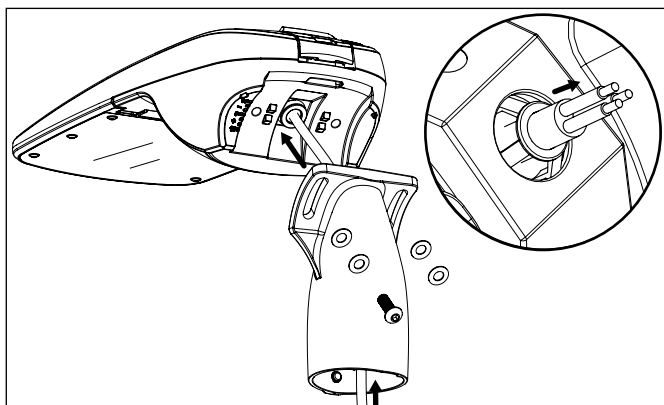

### Step 4 (See Step 4A for Side Entry installation instructions)

Fit entry to lantern with supplied fasteners, tightening to **16Nm** torque. 4x Disc spring washers must be installed in the correct orientation.

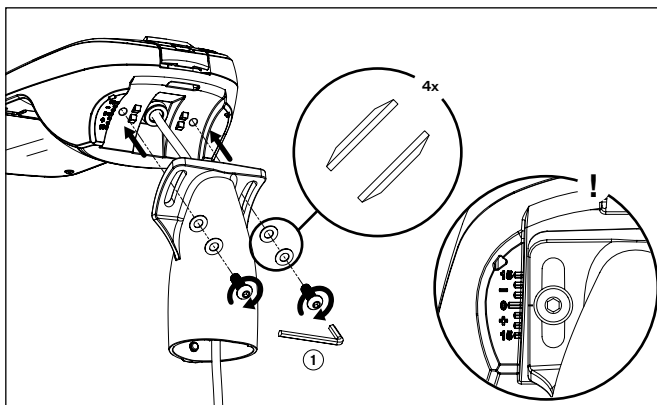

**Note!** Ensure entry is aligned to desired mounting angle.

### Step 5 (See Step 5A for Side Entry installation instructions)

Loosen 2x M10 grub screws on entry with torque wrench (5mm). Slide entry on to column (See column table). Tighten grubs screws to 16Nm.

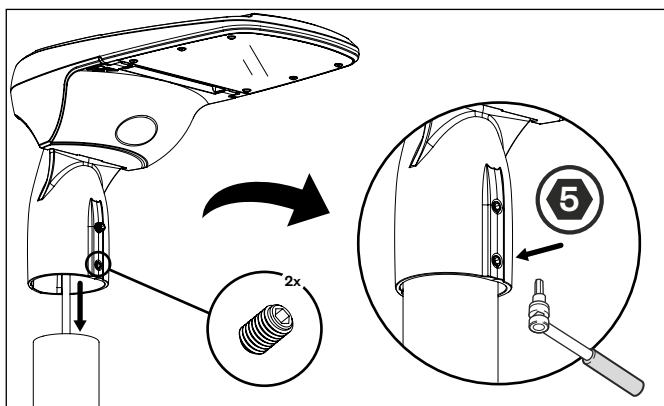

**Note!** Align lantern with area to be illuminated

### Step 6

Undo quick-release rear latch, and leave the latch in the open position.

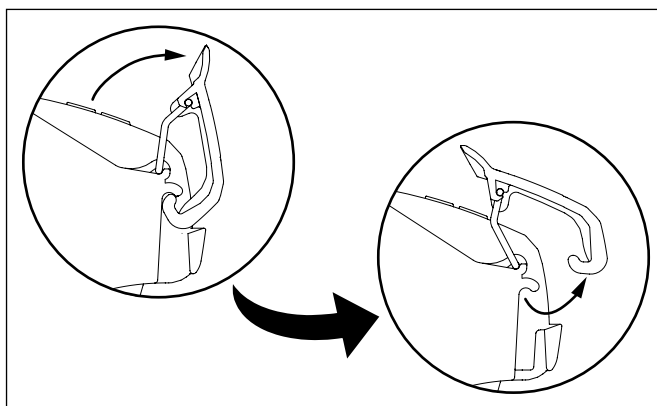

LEDs contained within this luminaire shall only be replaced by the manufacturer, their service agent or similar qualified person. The Live Supply is insulated (basic) from the DALI conductor.



DW Windsor

Pindar Road, Hoddesdon, Hertfordshire, EN11 0DX  
T: +44 (0) 1992 474600 | E: info@dw Windsor.com

www.dwwindsor.com

## Kirium Pro Midi Installation Steps | Post Top Entry

### Step 7

Pivot head to 90° away from base to allow for access to internals for wiring.

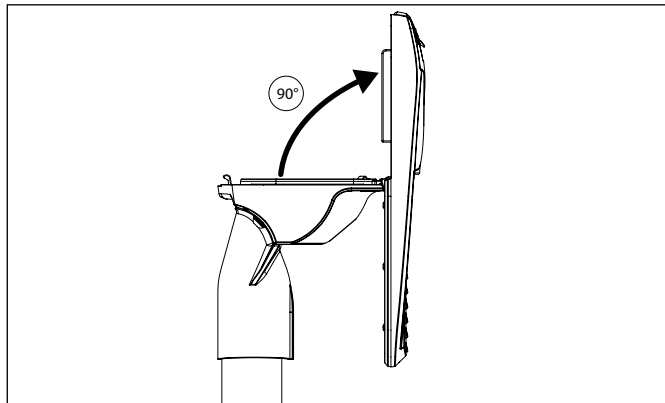

### Step 8

Wire cable to electrical terminal block with Slotted Screwdriver.

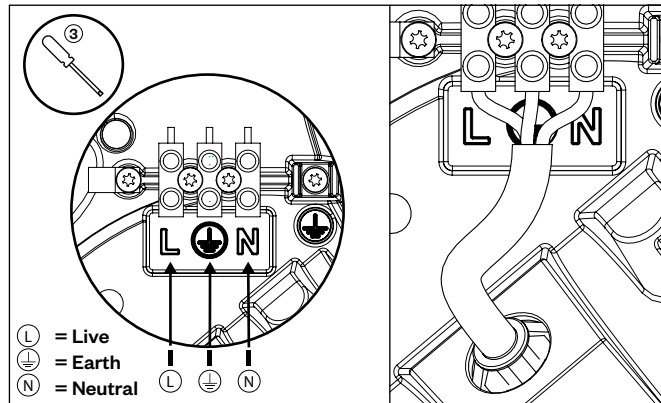

### Step 9

Close lantern and fasten quick-release side latches.

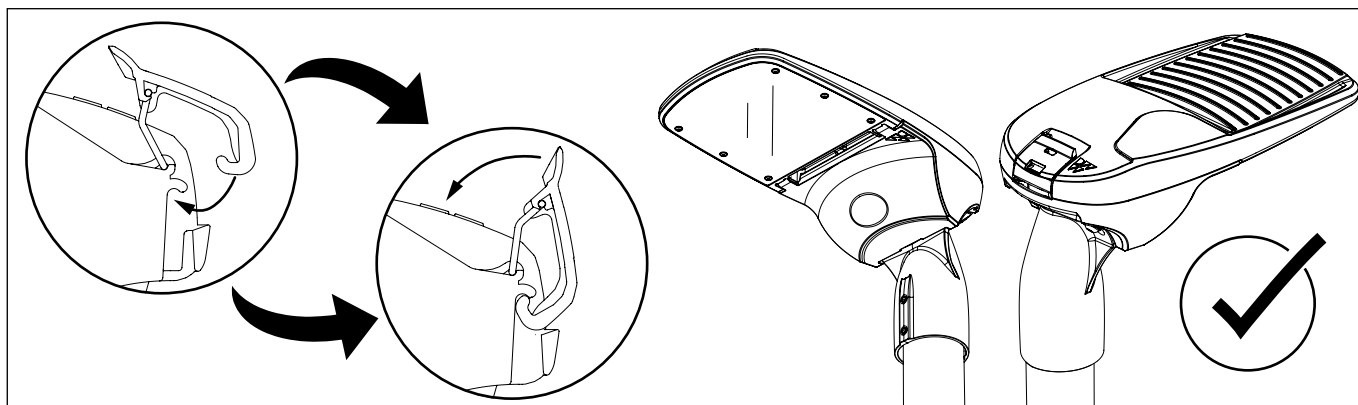

## Kirium Pro Midi Installation Steps | Side Entry

### Step 4A

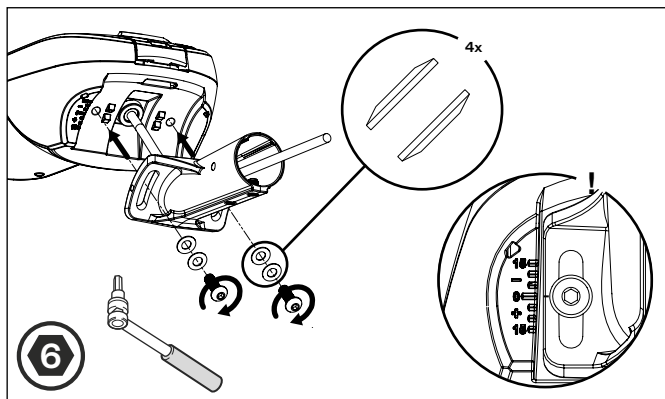
Fit entry to lantern with supplied fasteners, tightening to **16Nm** torque. 4x Disc spring washers must be installed in the correct orientation.

Note! Ensure entry is aligned to desired mounting angle.

### Step 5A

Loosen 2x M10 grub screws on entry with 5mm allen key. Slide entry on to column (See column engagement table). Tighten grub screws to 16Nm.

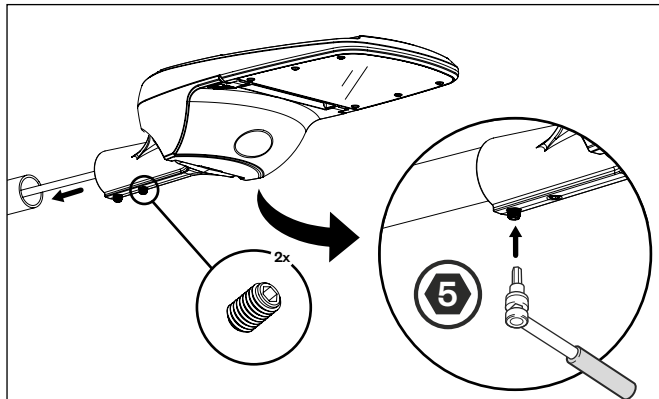

Note! Align lantern with area to be illuminated

### NOTE!

To replace broken safety glass, please contact DW Windsor for replacement, quoting the product serial number.



### DW Windsor

Pindar Road, Hoddesdon, Hertfordshire, EN11 ODX  
T: +44 (0) 1992 474600 | E: info@dw Windsor.com

www.dwwindsor.com

## Anti-Glare Shield

Anti-Glare Shields can be fitted to the luminaire post-installation, without opening the product. It requires the use of a T20 Torx Driver to loosen glass mounting screws to retain the Front and / or Rear Anti-Glare Shield(s). Screws to be tightened to 2 Nm Torque.

## Components Supplied

1 x Anti-Glare Shield Front  
1 x Anti-Glare Shield Rear  
2 x Anti-Glare Shield Side

## Tools Required

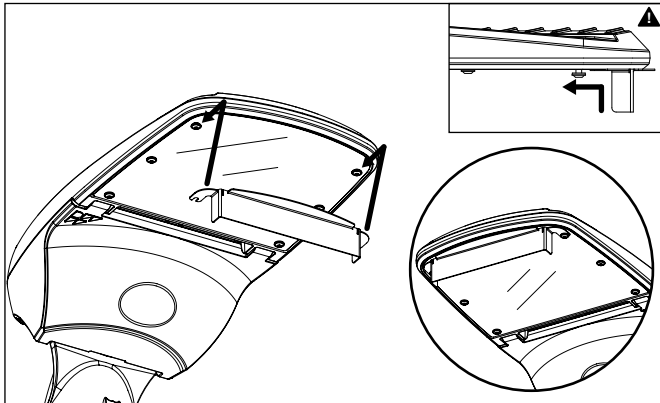
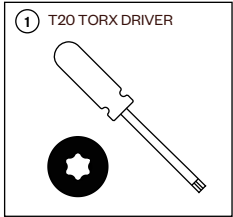

▲ Anti-Glare Shield Front Installation - Note: Glare Shield To Be Screwed Under Screw Head And Nylon Washer (2 Nm torque for screws).

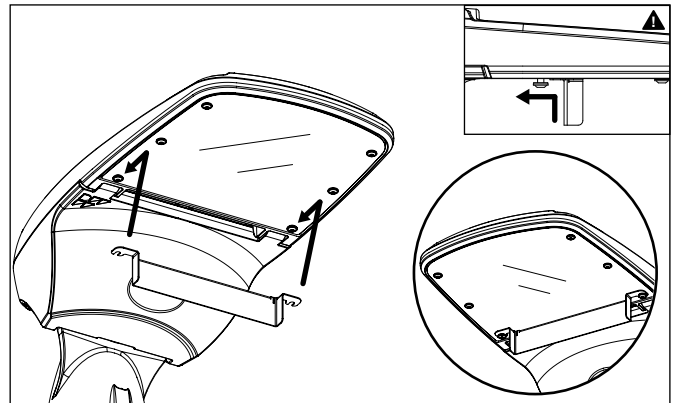

▲ Anti-Glare Shield Rear Installation - Note: Glare Shield To Be Screwed Under Screw Head And Nylon Washer (2 Nm torque for screws).

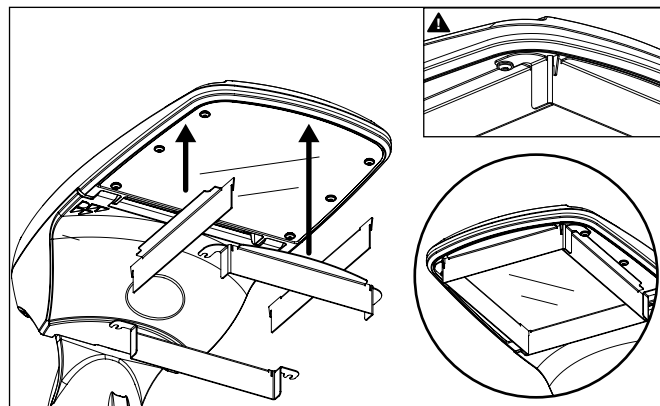

▲ Anti-Glare Shield Full Installation - Note: Side Glare Shields Slot Under Front & Back Glare Shields.