



Anello LED

IP67 IK10
CLASS III

architectural

- Supplied with galvanised steel sub-frame
- Easy to use IP68 plug and socket connector system
- Available in two different diameters
- Available in one piece (circular) or two piece (semi-circular) versions



Circular LED 220

NEW

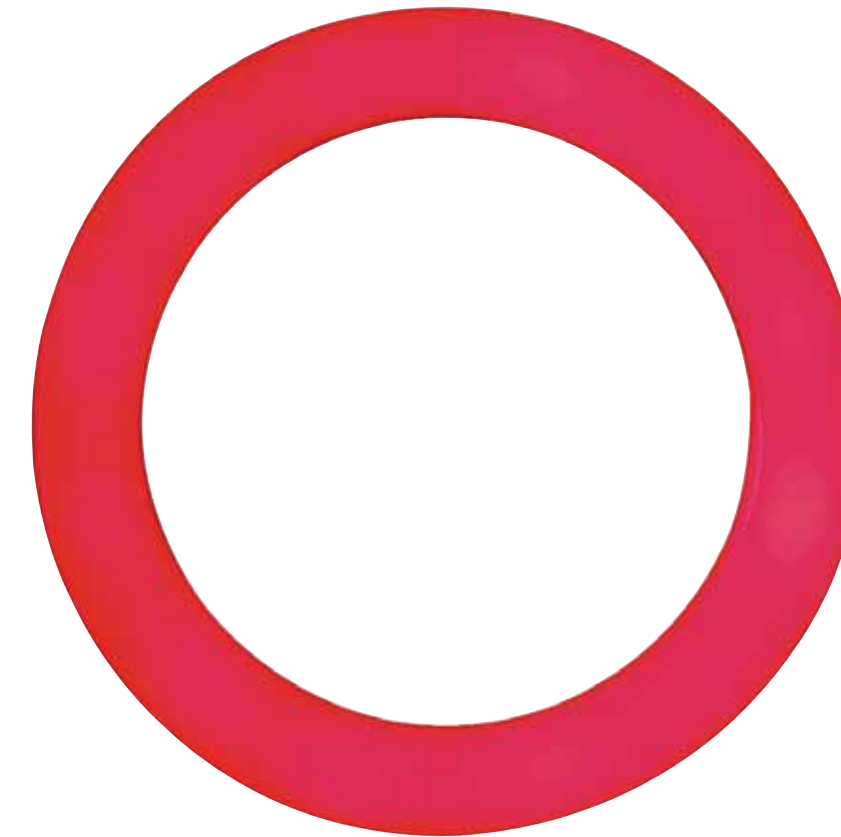

Options

Styles:
Anello LED 220
Anello LED 280

Glazing:
Integral opaque surface

Lamp:
White LEDs
Blue LEDs
Green LEDs
Red LEDs
Amber LEDs

Mounting:
Galvanised steel two-part sub-frame

Other:
24v DC power supplies available as required on project-by-project basis

Materials

Body:
Aluminium

Glazing:
Structural Polyurethane

Connectors:
IP68

Anello LED Product Codes

Anello LED		Example
1. Model		
ANE		ANE
2. Size		
220	220mm outer diameter	220
280	280mm outer diameter	
3. Style		
1	One Piece	1
2	Two Piece	
4. Lamp		
R	Red LEDs	B
W	White LEDs	
B	Blue LEDs	

Open front cover flap for our guide to using this table.

Example Code:

- 1. **ANE** Anello LED
- 2. **220** 220mm outer diameter
- 3. **1** One-piece version
- 4. **B** with blue LEDs

= ANE 220 1 B

Please check our website dwwindsor.co.uk for the latest information on new products or contact us on 01992 474600

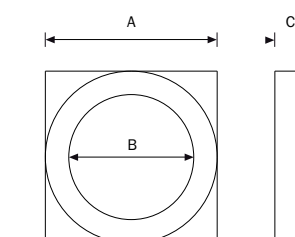

Variant	Dimensions (mm)			Weight (kg)
	A	B	C	
220	220	160	40	5.0
280	280	220	40	6.0