

Installation Instructions



IMPORTANT

- DISCONNECT ELECTRICAL SUPPLY BEFORE INSTALLATION OR SERVICING.
- THIS PRODUCT MUST BE EARTHED.
- THIS PRODUCT IS DESIGNED TO OPERATE OUTDOORS. IF REQUIRED TO BE USED INDOORS PLEASE CONSULT DW WINDSOR.
- THIS PRODUCT IS FITTED WITH TOUGHENED GLASS.

IP66 IK09



230VAC 50Hz

Product Details

Variant	Dimensions (mm)				Max. Weight (kg)
	A	B	C	D	
Flange Plate	160	55	1000	-	6
	160	55	600	-	4.3
	160	55	400	-	3.6
Integral Root	160	55	1000	300	6.1
	160	55	600	300	4.7
	160	55	400	300	4
Bolt on Root	160	55	-	300	1.8

Mounting Options

Mounting Options	Fig.
Flange Plate	2
Flange Plate & Bolt on Root	3
Integral Root	4

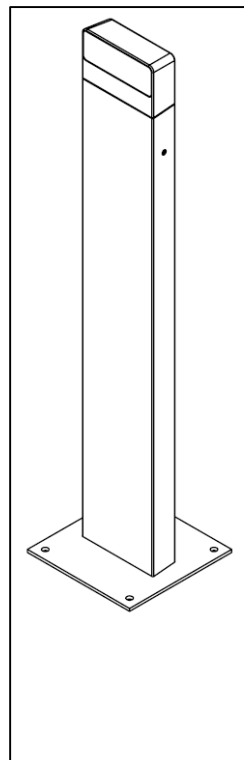

Fig. 2 - Ren 160 Flange Plate

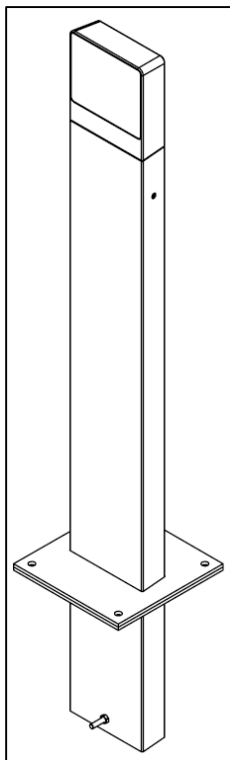

Fig. 3 - Ren 160 Flange Plate & Bolt on Root

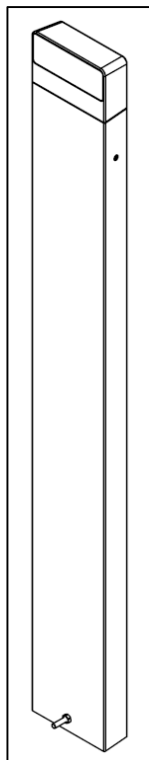

Fig. 4 - Ren 160 Integral Root

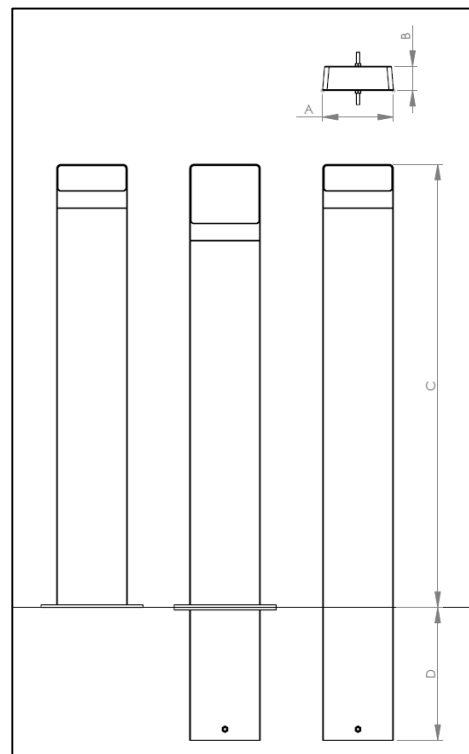

Fig. 1 - Ren 160 Range

Tools Required

Tools not supplied.

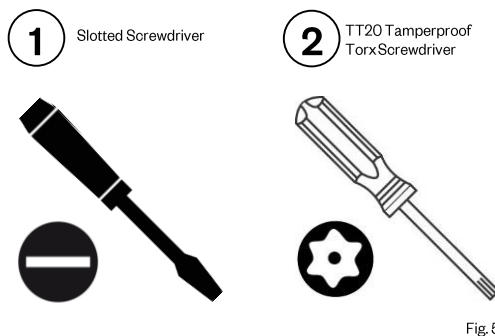

Fig. 5

Due to continuous product development the details within this document are subject to change at any time, please contact us for the most up-to-date information or visit: www.dwwindsor.com

DW Windsor
Pindar Road, Hoddesdon, Hertfordshire, EN11 ODX
T: +44 (0) 1992 474600 | E: info@dwwindsor.com
www.dwwindsor.com

Ren Installation Steps | Flange Mount

Step 1

Assemble the bollard base directly to the foundations using the four fixing holes on the flange plate. Check orientation of head and secure base with M10 anchor bolts.

Mains supply cable must enter bollard from below. Ensure there is a minimum 100mm excess mains cable protruding from the top of the bollard for fitment of the LED head unit.

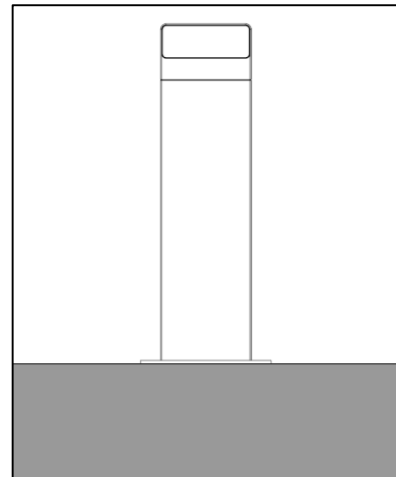
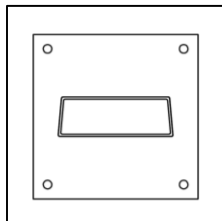

Ren Installation Steps | Integral Root Mount

Step 1

Assemble anti-lift out M8 bolts and nuts in the holes at the bottom of the bollard with the bolts facing outwards.

Step 2

Install the bollard in the ground observing the correct bollard height and head orientation.

Mains supply cable must enter bollard from below. Ensure there is a minimum 100mm excess mains cable protruding from the top of the bollard for fitment of the LED head unit.

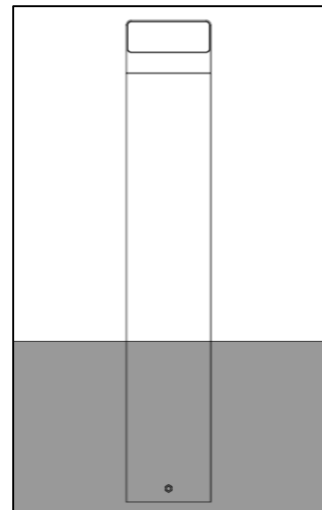
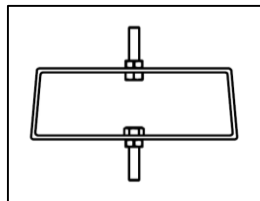

Ren Installation Steps | Bolt On Root & Flange Mount

Step 1

Assemble anti-lift out M8 bolts and nuts in the holes at the bottom of the bolt on root bollard with the bolts facing outwards.

Step 2

Install the bolt on root bollard in the ground observing the correct bollard height and head orientation. Mains supply cable must enter bollard from below.

Step 3

Assemble the flange plate bollard base directly to the bolt on root using the four fixing holes on the flange plate. Check orientation of head and secure base with M10 anchor bolts.

Ensure there is a minimum 100mm excess mains cable protruding from the top of the bollard for fitment of the LED head unit.

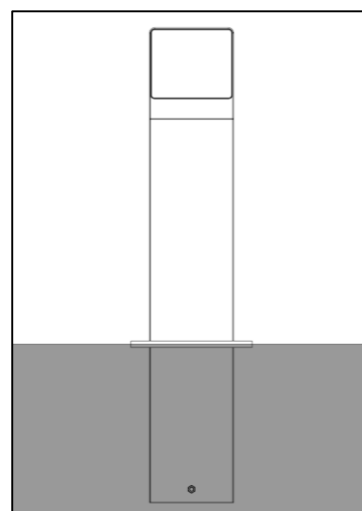
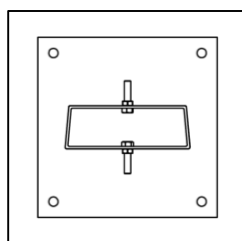

NOTE!

LEDs contained within this luminaire shall only be replaced by the manufacturer, their service agent or similar qualified person.



DW Windsor

Pindar Road, Hoddesdon, Hertfordshire, EN11 0DX
T: +44 (0)1992 474600 | E: info@dw Windsor.com
www.dw Windsor.com

Ren Installation Steps | Bollard Head Unit

Step 1

Turn off mains power. Strip the mains cable protruding from the bollard to the lengths specified on the diagram below.

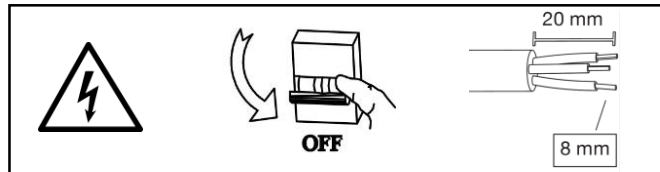

Step 3

Terminate live, neutral and earth cables into the terminal block. These positions are marked on the terminal block with an L, N and \oplus .

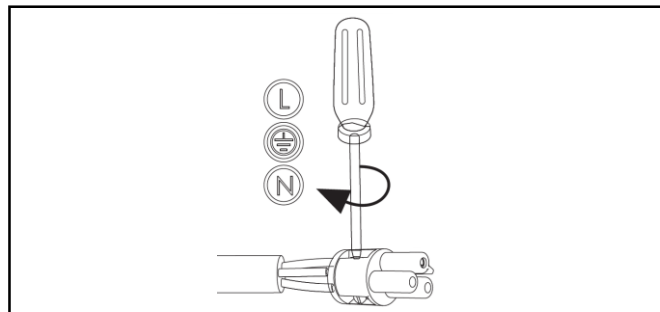

Step 5

Tighten the gland fully around the mains cable in order to IP protect the product.

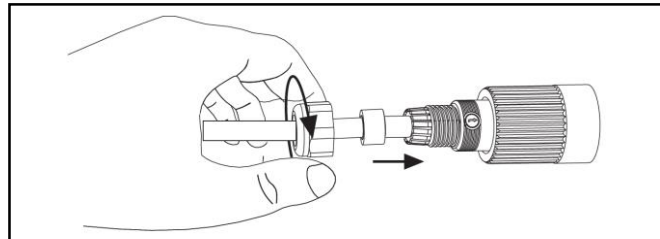

Step 7

Fit the head unit into the bollard and hand tighten the M4 tamperproof screws attaching the head unit securely onto the bollard. Once cable routing has been completed and checked, mains power can be restored.

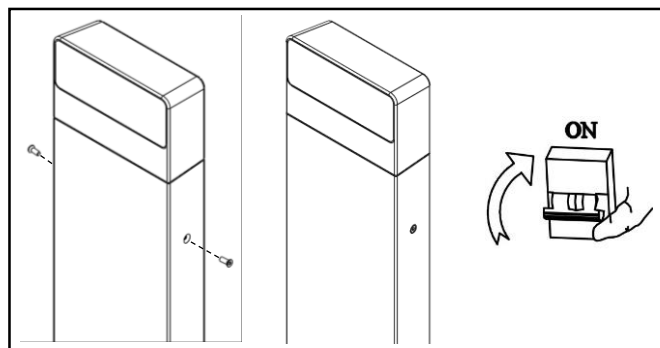

Step 2

Assemble the connector parts onto the mains cable in the order shown on the diagram below.

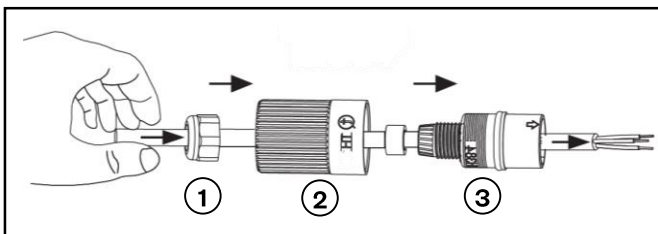

Step 4

Push the terminal block into position ensuring it is in the correct orientation, it should click into position when fitted correctly.

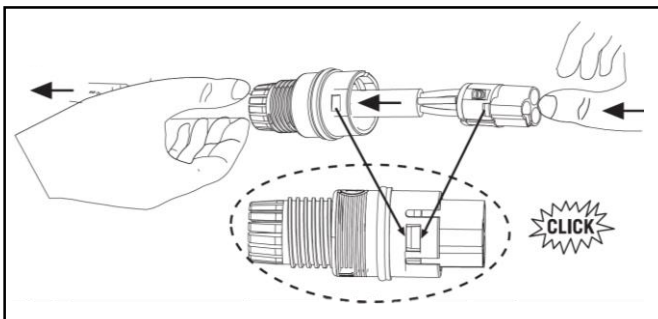

Step 6

Attach the mains cable connector to the head unit connector, tighten the connectors together fully in order to IP protect the product.

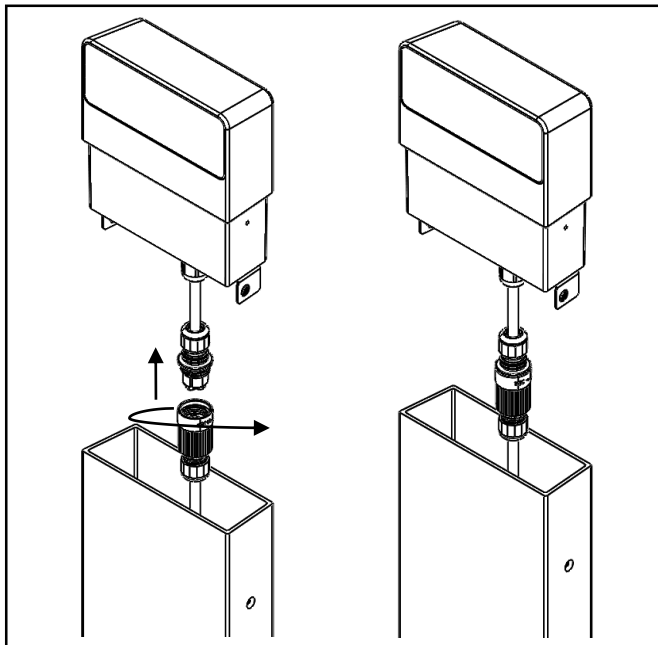

NOTE!

LEDs contained within this luminaire shall only be replaced by the manufacturer, their service agent or similar qualified person.



DW Windsor

Pindar Road, Hoddesdon, Hertfordshire, EN11 0DX
T: +44 (0)1992 474600 | E: info@dw Windsor.com
www.dw Windsor.com