

NORDSTROM 3 (NOD-50021)



Product description

Integral control gear - 120x120 mm - Class I



Luminaire Structure

- Die-cast aluminium housing
- Pre-treated before powder coating ensuring high corrosion resistance
- Thermal heat dissipation body
- Single cable entry, through wiring upon request

- One IP68 connector supplied with 0.2 m of 3x1.0 sqmm outdoor cable for NOD-50001, NOD-50011, NOD-50021, NOD-50031
- One IP68 connector supplied with 0.2 m of 8x0.5 sqmm outdoor cable for NOD-50002, NOD-50012, NOD-50022, NOD-50032
- Stainless steel fasteners in grade 304 with zinc flake coating (ZFC)
- Durable silicone rubber gasket

- High-efficiency PMMA lens
- Clear toughened glass
- Integral control gear

Light symbol

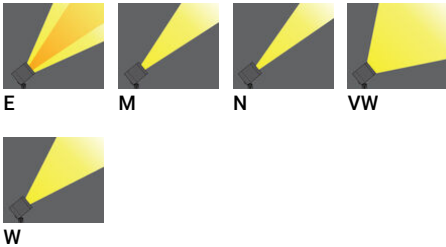

Product colour

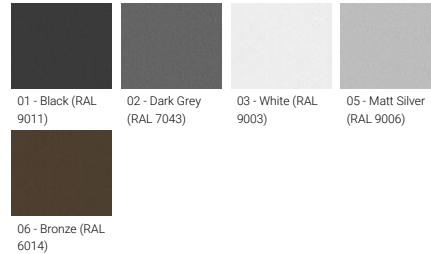

Special finishes upon request

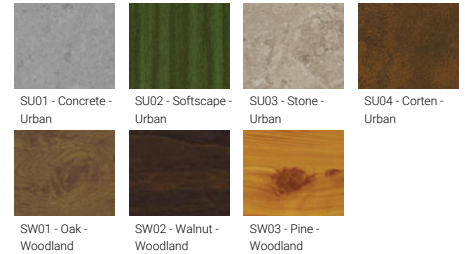

NORDSTROM 3 (NOD-50021)

Technical information

Material	Aluminium
Light source	9 LED
Power (Luminaire)	21 W
Lumen (Luminaire)	1921 - 2364 lm
Luminaire luminous efficacy	91 - 113 lm/W
Driver option	Integral control gear
Driver	Constant current (CC)
Input voltage	220-240 V 50/60 Hz
Optic	E, M, N, VW, W
Optic value	10°, 17°, 34°, 43°x11°, 70°

Optic (2nd)	M, VW, W
Optic (2nd) value	23°, 32°, 43°
CCT / CRI	3000K CRI80, 4000K CRI80
Bug	B2-U0-G0, B3-U0-G0
ULR	0%
ULOR	0%
CIE flux code n°3	100
Dimming type	DALI, On/Off
Product colours	Black, Dark Grey, White, Matt Silver, Bronze, Concrete - Urban, Softscape - Urban, Stone - Urban, Corten - Urban, Oak - Woodland, Walnut - Woodland, Pine - Woodland
Weight	2.7 kg

Operating temperature	-20 °C to 40 °C
Through wiring	Single cable entry, through wiring upon request
Lens / Reflector / Optic	High-efficiency PMMA lens, Clear toughened glass
MacAdam Ellipse	3 SDCM
Lifetime L90B10 (hours)	> 120,000
Lifetime L80B10 (hours)	> 120,000
Lifetime L80B50 (hours)	> 120,000
Variants DALI)	Compatible with EN/ IEC 60598-2-22: Suitable for emergency installations as central supply, non-maintained (ZO)

NOD-50021

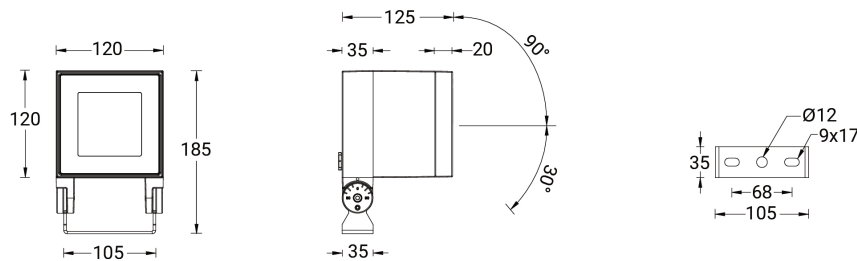

Accessories

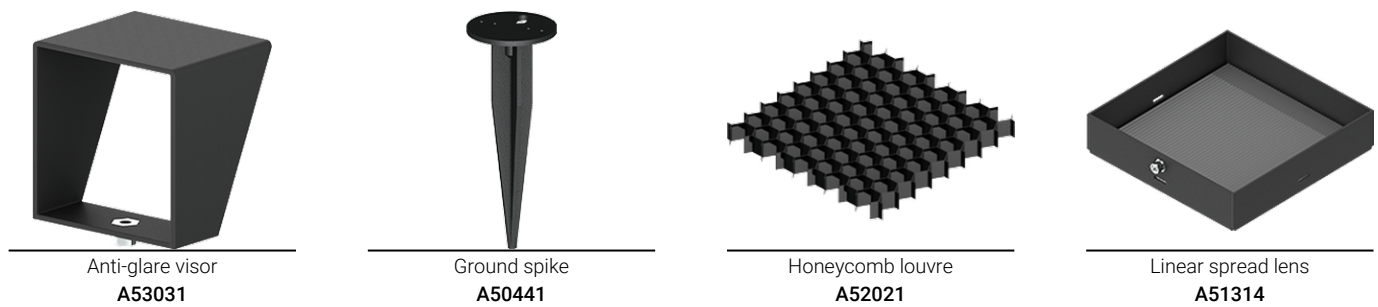

NORDSTROM 3 (NOD-50021)

DALI Control System
Control-DALI

Please contact the factory for technical details if you wish to use Anti-glare accessories, Colour filters, Lenses and slip glasses in combination.